

# REALPTT Patrol 2.0 function introduction

---

1、 Overview.....	3
1.1 Patrol map.....	4
1.2 Patrol software and main workflow description.....	4
1.2.1 Software division of patrol 2.0.....	4
1.2.2 Patrol workflow.....	5
2、 Company platform patrol management.....	5
2.1 Patrol Site.....	5
2.1.1 Add GPS positioning patrol site.....	6
2.1.2 Increase NFC patrol points.....	7
2.1.3 Default NFC patrol point.....	10
2.1.4 Activate NFC card.....	10
2.2 Patrol plan.....	11
2.2.1 Create a patrol plan.....	11
2.2.2 Batch creation of patrol plans.....	12

2.2.3 Add patrol user.....	13
2.3 Group batch operation.....	14
2.3.1 Patrol point grouping.....	14
2.3.2 Plan Group.....	16
2.4 User.....	18
2.5 Patrol User.....	19
2.6 User Group.....	21
2.7 Patrol record.....	21
2.7.1 statistics.....	21
2.7.2 Patrol Record Query.....	23
2.7.3 Event Record Query.....	23
2.8 Dispatcher user.....	24
2.9 Mail Task.....	25
2.10 company information.....	25
3、RealPTT Mobile dispatching desk.....	26
3.1.Patrol check-in.....	26
3.2. Patrol reminder.....	28
3.3. Automatic sign in.....	29
3.4 Error handling.....	29
4、Computer side of patrol dispatching desk.....	29
4.1 Patrol plan.....	29

4.2.Patrol event.....	30
4.2.1Patrol event reminder.....	30
4.2.2 Overtime plan.....	31
4.2.3Patrol event.....	32
4.3 Export report.....	32
4.4 Patrol settings.....	32

## 1、 Overview

The patrol function is suitable for a variety of scenarios, such as work attendance, fixed-point patrol, equipment maintenance, etc. The establishment of the electronic patrol system makes the patrol security work more scientific and reasonable, and makes the safety management more standardized, standardized and institutionalized. The management staff set up patrol lines and set patrol points on the patrol lines. Through the patrol management department, the patrol personnel are scheduled to form a prevention network in the patrol area, which further improves the work efficiency of patrols. It reduces the work intensity of the patrol personnel, saves manpower, and forms a comprehensive, multi-level, high-performance patrol management system.

The new version of Patrol 2.0 has two main patrol modes:

①NFC patrol   ②GPS positioning patrol.

◆ NFC patrol needs hardware support: ①Cards with NFC function (supported models: NTAG213, NTAG215, NTAG216). ②The patrol equipment has NFC function.

◆ GPS positioning patrol: Use equipment with GPS positioning function.

## 1.1 Patrol map

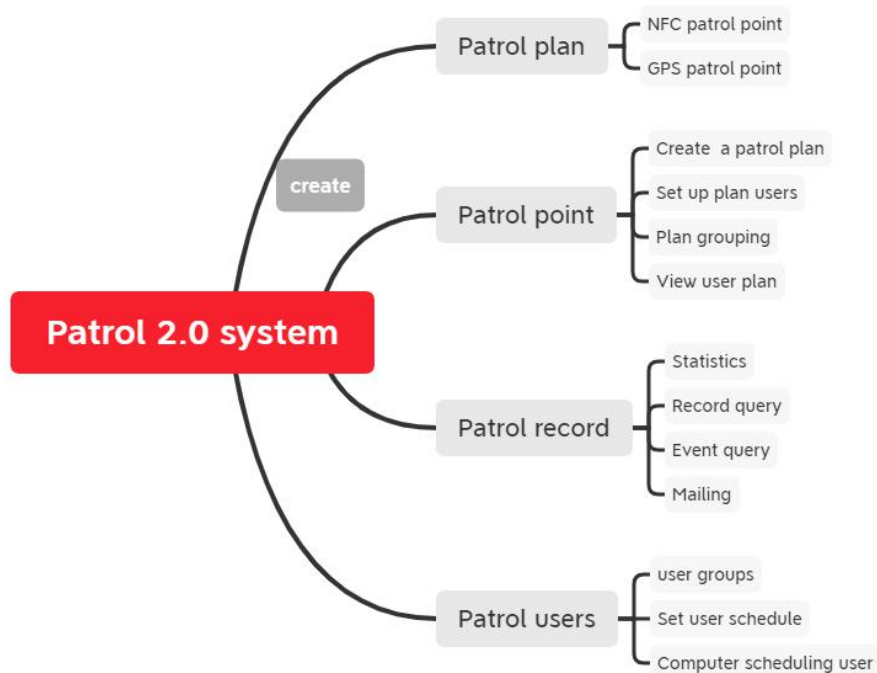

## 1.2 Patrol software and main workflow description

### 1.2.1 Software division of patrol 2.0

- ◆ **Patrol 2.0 management system:** Add patrol points (\* NFC patrol points need to be used with corget NFC programming software), create patrol plan, add users with patrol function to patrol plan, count patrol record information, set computer dispatching station users and email sending, etc.
- ◆ **REAL-PTT Mobile app:** log in the user account, get the patrol reminder, automatically sign in for the patrol, and take the initiative to patrol (and select the event result for patrol, which can input text, video, picture and audio for Patrol).
- ◆ **Mobile app terminal of patrol dispatching console:** It is necessary to log in the patrol scheduling user account, query the details of planned patrol, query the users without patrol, event query (preset event, video, text, audio, picture), patrol notice.
- ◆ **Computer terminal of patrol dispatching console:** It is necessary to

log in the patrol scheduling user account, query the planned patrol details, query the non patrol users, event query (preset event, video, text, audio, picture), patrol notification pop-up window, and export the patrol report.

### 1.2.2 Patrol workflow

The patrol function is mainly composed of patrol plan, patrol point, patrol user, client software and patrol record. A complete patrol includes at least: a patrol point-a plan-a user (you need to check the patrol 2.0 permission).

**To complete a tour, at least the following steps need to be completed:**

- 1) Add a GPS positioning patrol point or NFC patrol point.
- 2) Add a patrol plan, select the corresponding patrol point and patrol plan to bind and increase.
- 3) Add the corresponding user (with patrol 2.0 permissions) to the registered patrol plan.
- 4) The user uses the patrol device for patrol within the effective time of the patrol plan..

※ The user uses the patrol device for patrol within the effective time of the patrol plan.

## 2、 Company platform patrol management

### 2.1 Patrol Site

Patrol points mainly include GPS positioning patrol points and NFC patrol points.

In the **[Site]** menu, click **[Add]** to start adding patrol points.

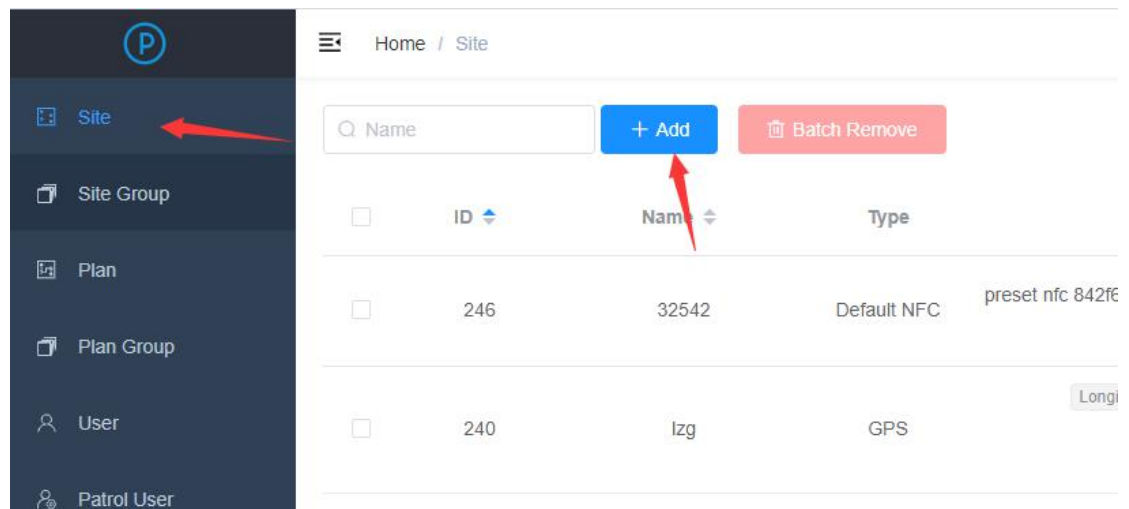

### 2.1.1 Add GPS positioning patrol site

Added steps: input the name of the patrol point, select GPS verification, and then locate the location by searching the name of the location, or manually drag the red balloon on the map to select the location. After entering the effective range of the patrol point, add the corresponding patrol events and results. Finally, save it directly.

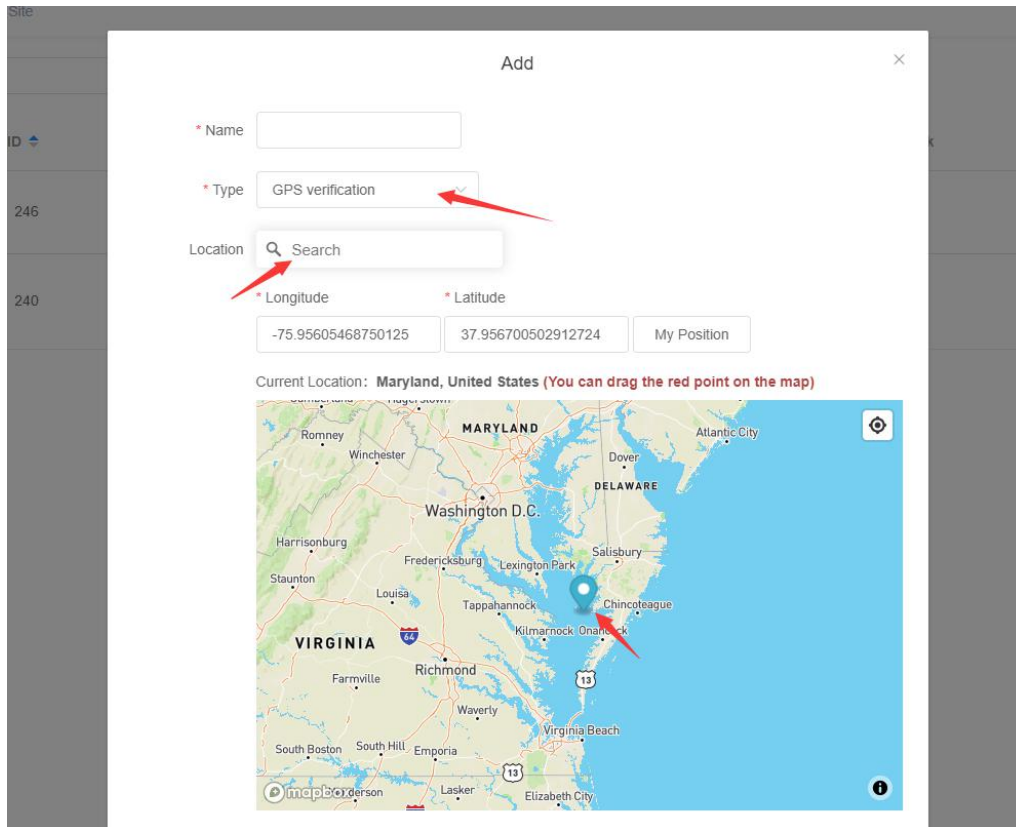
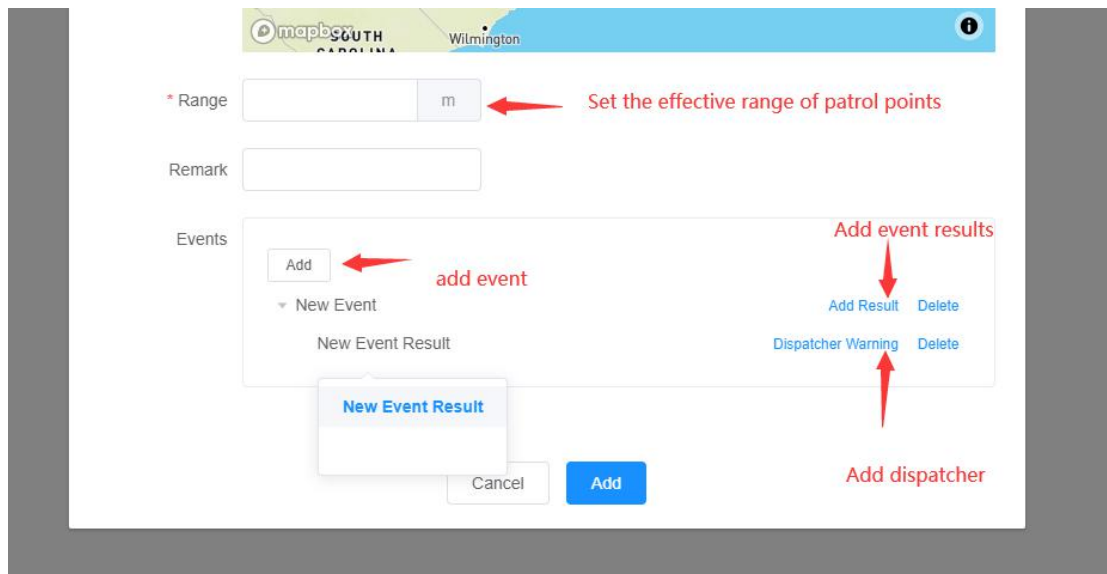
### 2.1.2 Increase NFC patrol points

Added step: Enter the name of the patrol point and select NFC verification. Then fill in the NFC card ID read by the NFC reading and writing software. Or first customize a card ID to fill in, and then bind the patrol point with the NFC card through the NFC reading and writing software.

Add ×

\* Name

\* Type

\* Card ID

Remark

Events

[Add Result](#) [Delete](#)

▼ New Event

New Event Result

[Dispatcher Warning](#) [Delete](#)

After the addition is completed, **open the corget NFC programming software**, and log in with the account password of the company management platform.

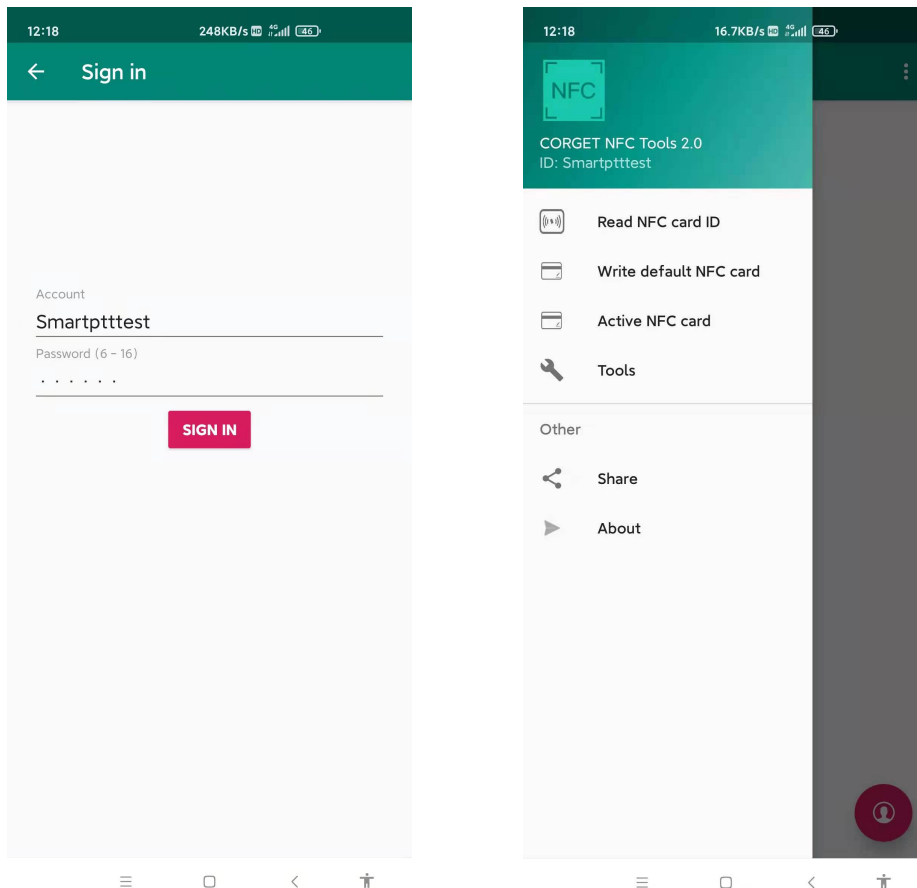

Click Write preset NFC card ID in the menu bar to see all the NFC patrol points created in the management platform. Then select a patrol point and bind the NFC card to the phone..

Note: An NFC card can only be bound to one patrol point. If the card is already bound to another patrol point, if you want to unbind it, you need to go to the management platform to clear the card ID that has been bound to the corresponding patrol point data.

- ◆ If the user has entered the correct card ID when adding a patrol point, then the NFC card and patrol point have been successfully bound, and there is no need to continue operations on this page.
- ◆ If the user needs to bind the original patrol point to a new NFC card, he can select a patrol point on this page for binding operation.
- ◆ If the user previously entered a custom or wrong NFC card ID, you can re-bind the card and the patrol point here.

### 2.1.3 Default NFC patrol point

Since the NFC card ID cannot be seen directly (it can be read with corget NFC programming software), and manual input is prone to errors, the NFC preset patrol point can be used to add the patrol point.

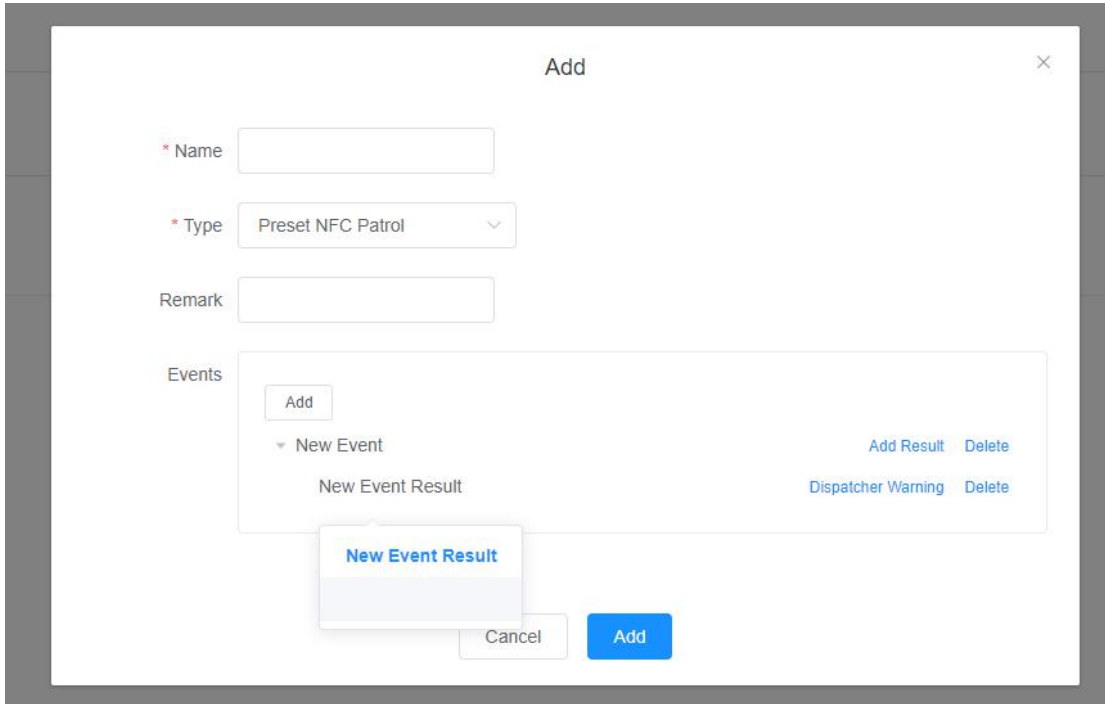

After the addition is complete, you can see the corresponding preset patrol points in the corget programming software, and then put the NFC card close to the NFC sensing area of the device and bind the patrol points.

### 2.1.4 Activate NFC card

Some NFC cards may need to be activated before they can use the NFC patrol function normally. When it appears that the card and the patrol point are bound, the user is also in the corresponding patrol plan. But when the device cannot successfully patrol, you can try to activate the card using the "Activate NFC Card" function in the NFC programming software menu and try again to see if the patrol can be successful.

## 2.2 Patrol plan

The patrol plan is used to specify the time range for the user to perform the patrol and the tasks that the patrol needs to perform, and the user needs to perform the patrol in the corresponding time period.

### 2.2.1 Create a patrol plan

After the patrol point is created, the patrol point needs to be bound to the patrol plan. When creating a patrol plan, you need to fill in the plan name, select the corresponding patrol point, use status, plan type and time zone and other options. After creation, the patrol plan can also be edited or deleted again.

Select **[Plan]** in the left menu bar, and then click **[Add]** to create a plan.

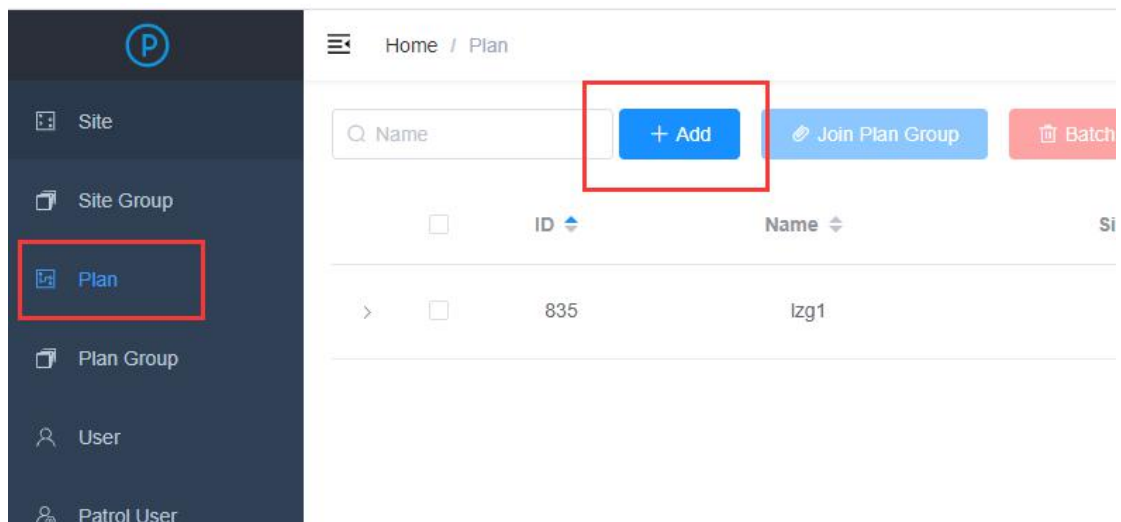

The screenshot shows the CORGET web interface. On the left, a dark sidebar contains a menu with items: Site, Site Group, Plan (highlighted with a red box), Plan Group, User, and Patrol User. The main content area has a breadcrumb 'Home / Plan' and a search bar 'Q Name'. Below the search bar, there are three buttons: '+ Add' (highlighted with a red box), 'Join Plan Group', and 'Batch'. Below the buttons is a table with columns: ID, Name, and Si. The table contains one row with ID '835' and Name 'lzg1'.

ID	Name	Si
835	lzg1	

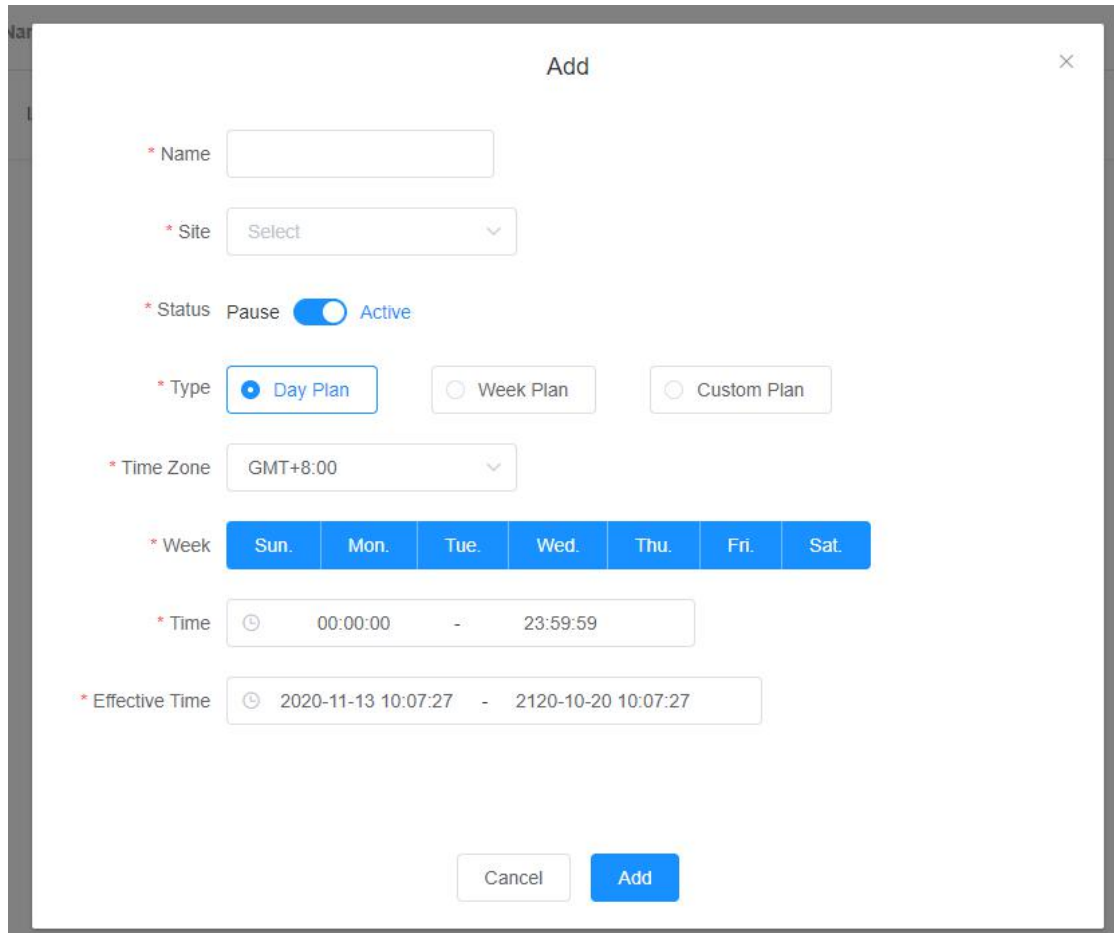

※ **Type:** Daily plan, weekly plan, custom plan. Daily plan, that is, a plan that needs to be patrolled every day, and the cycle is counted on a daily (24h) cycle. Weekly plan means to execute once within the effective time. The custom plan is a user-defined start time and end time, and there is no periodic cycle.

※ **Time Zone:** Specify the time zone for this planned patrol. When you open the browser, it will automatically get your current time zone. If the time zone matches the current situation, you don't need to change this value. If the time zone of the patrol destination is different from the default display, manually modify it to the correct time zone.

**Note: A plan is bound to a patrol point. If a patrol point needs to be patrolled in multiple periods, multiple plans can be set;**

### 2.2.2 Batch creation of patrol plans

To improve efficiency, you can also create multiple patrol plans at once in batches. First, you need to download the plan template and fill it out according to the filling rules at the top of the template. You don't need to fill in the content that can be empty, and you can modify it later.

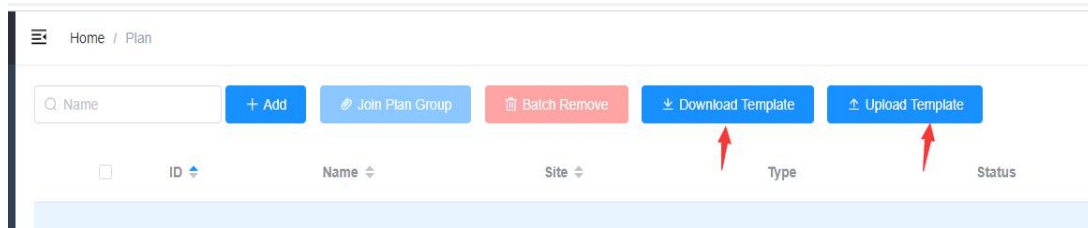

	A	B	C	D	E	F
1	site name	site type	site value	user account	rule name	rule type
2	site name Use only characters and numbers. If you include special characters, this rule will write failed.	<NFC> or <GPS> or <NFC PRESET>. Default value is NFC PRESET.	Type NFC value is card id like <04983732DA6180>. If the card id is incorrect, your patrol will fail. Type GPS value is latitude and longitude and distance like <{"longitude":113.9431,"latitude":22.556,"distance":1000}>.1000 means gps patrol range is 1000 meters. Type NFC PRESET site value is blank, you must update NFC card id	The user must exist.	rule name Use only characters and numbers. If you include special characters, this rule will write failed.	<daily> or <weekly> or <userdefine>. Default value is daily.
3	example patrol site 1	NFC	04983732DA6180	yctestaccount001	example rule 10PM	daily
4	example patrol site 2	GPS	{"longitude":113.9431,"latitude":22.556,"dis	yctestaccount001	example rule start	daily
5	example patrol site 3			yctestaccount002	example rule off	
6	example patrol site 4	NFC PRESET		yctestaccount002	example rule 001	weekly
7	example patrol site 5	NFC PRESET		yctestaccount003	example rule 0012	userdefine
8						
9						
10						
11						

Template filling rules

Save it after filling in, and then click "Upload Template" on the management page to upload.

### 2.2.3 Add patrol user

After creating a patrol plan, click on the "Set User" corresponding to the far right of a plan to add users who need to participate in the corresponding plan to the plan.

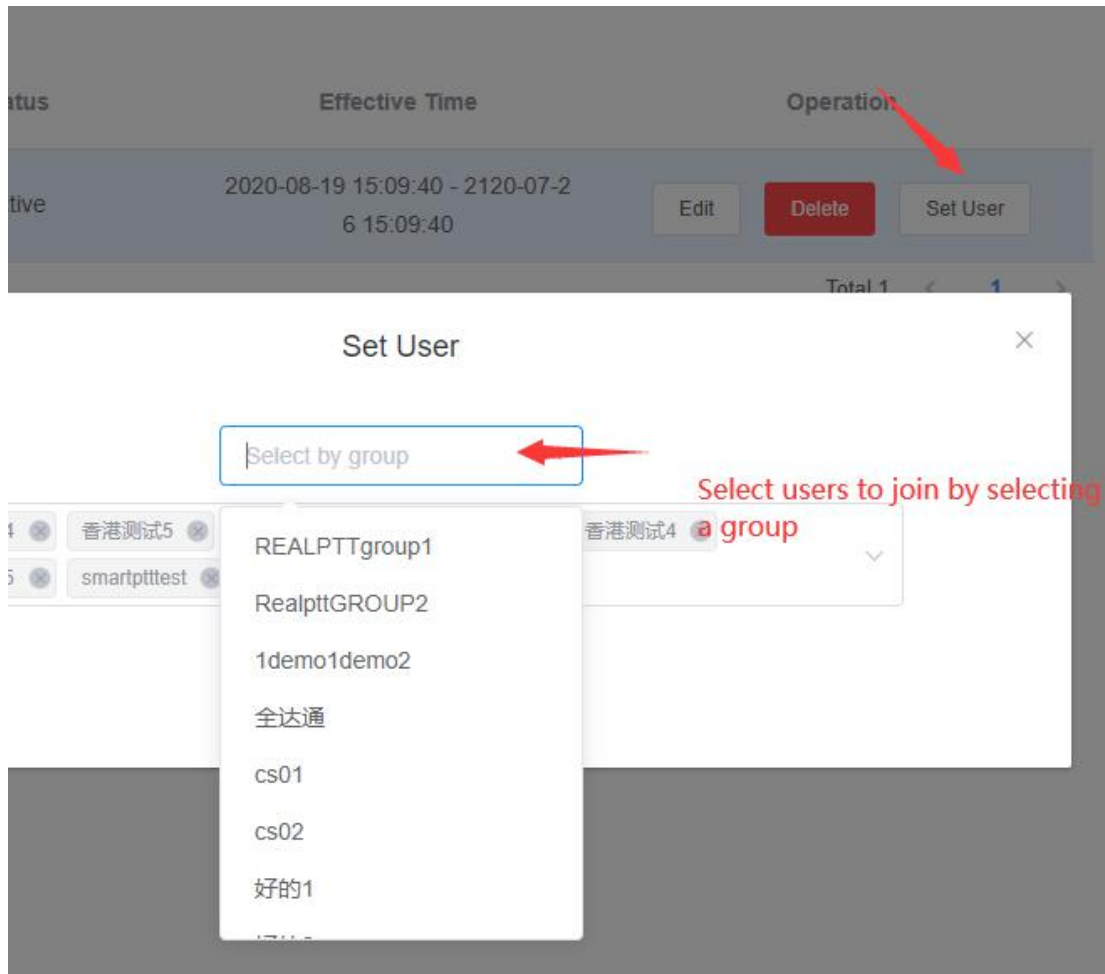

After selecting a group, users with the patrol function of the group will appear below, and you can add them individually or select all.

## 2.3 Group batch operation

When the user has multiple patrol points that need to be bound to the created plan, the patrol point grouping and plan grouping functions can be used. Used to perform batch operations to improve efficiency.

### 2.3.1 Patrol point grouping

To quickly create a patrol plan for multiple patrol points, you can do as follows:

Create a patrol point group (line), and then add multiple patrol points to this group. Go to the plan list page, add a plan, and select this group to add it.

- 1) First click [Add] to create a patrol point group, and then click [Set Patrol

Point] to add the patrol point to the patrol point group.

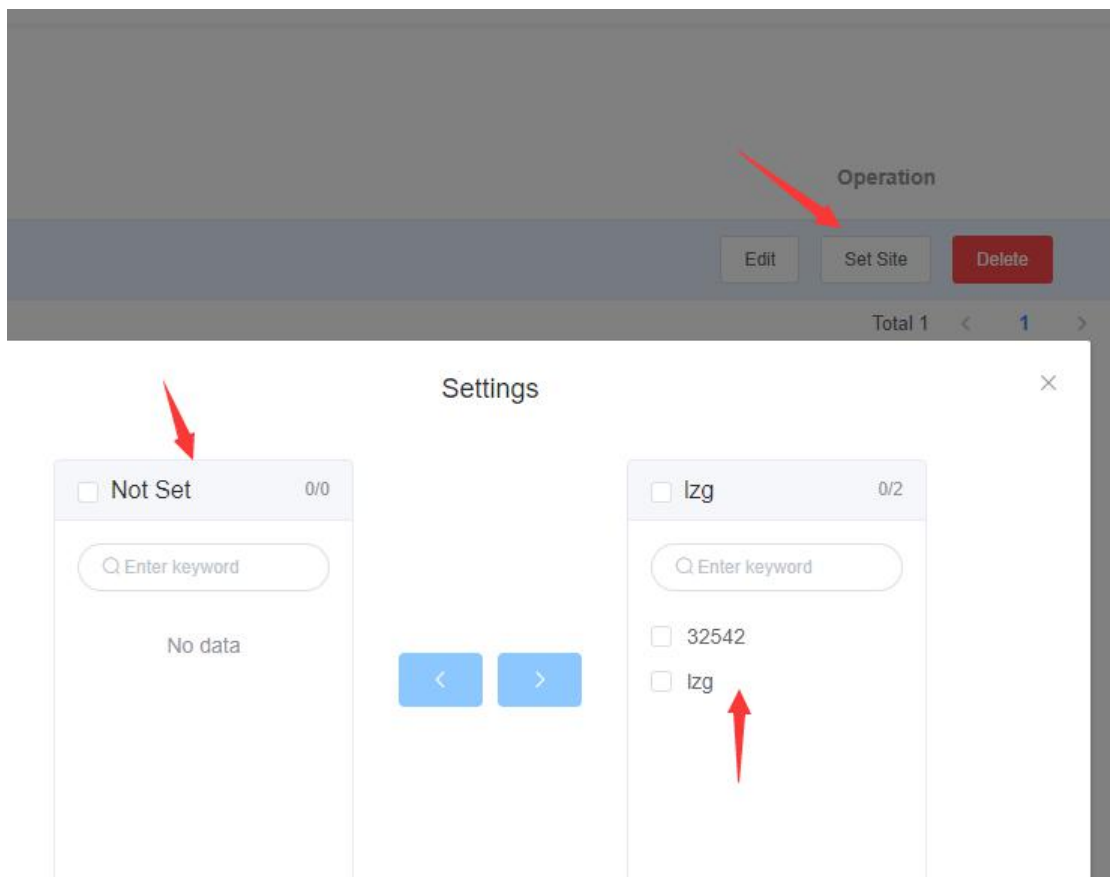
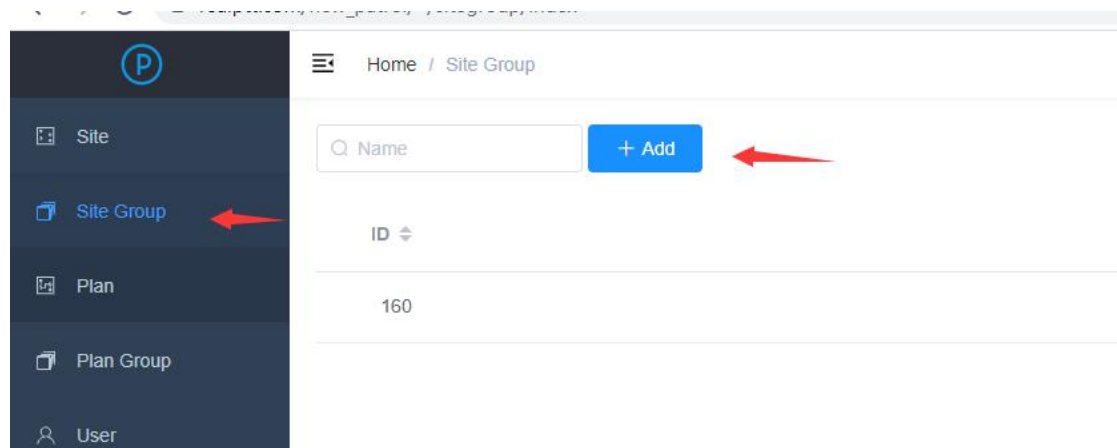

2) Use patrol points to group batches to generate patrol plans;

Click the **[Plan]** menu, and then click **[Add]**.

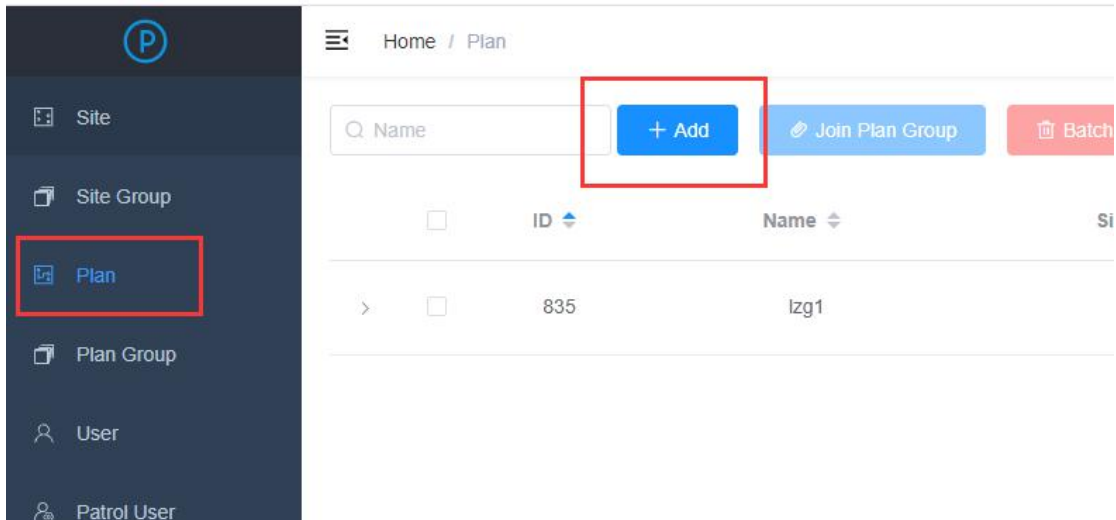

In the new plan interface, in the patrol point column, find [patrol point group], select the patrol point group you just created, fill in other items and submit it, and multiple patrol plans will be generated in batches.

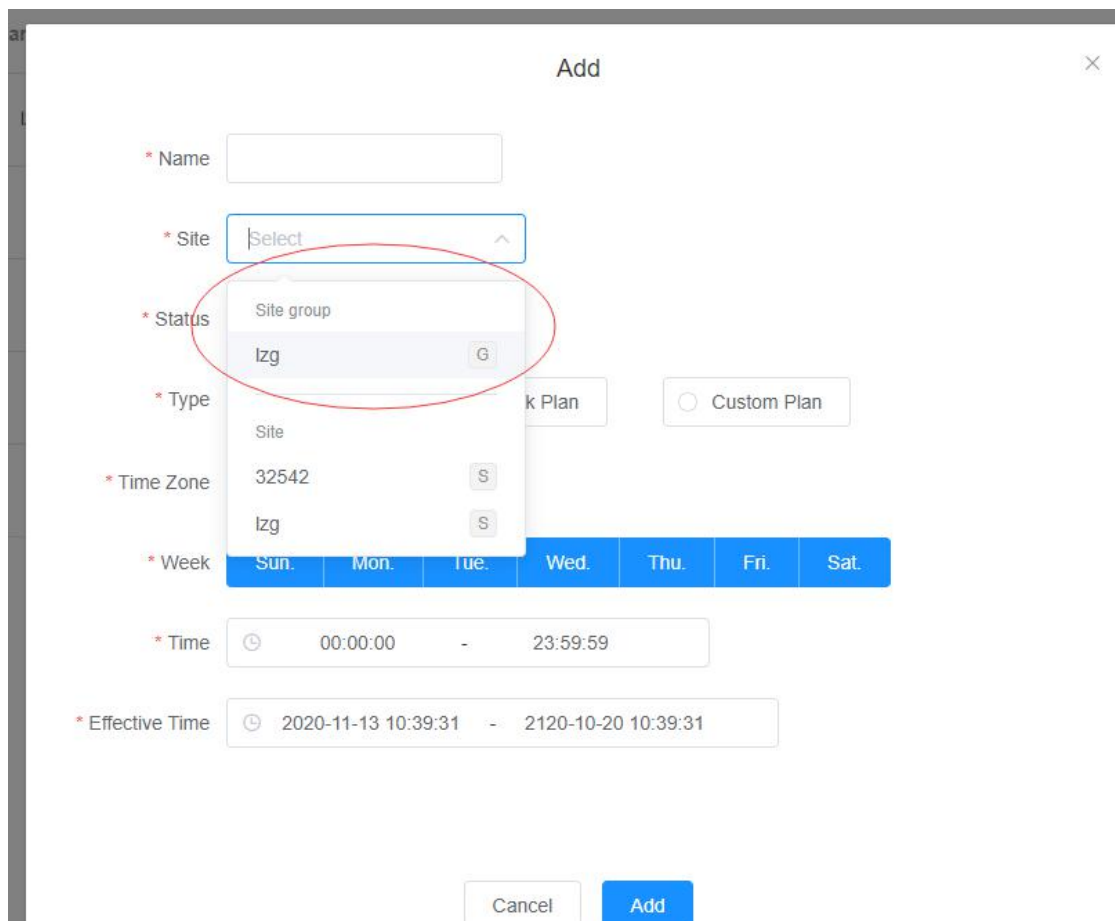

### 2.3.2 Plan Group

When users need to join multiple patrol plans, in order to make the

operation faster, you can use the plan grouping function. Group the patrol plans that users need to join into the same plan group, and then set user operations on this plan group, and add users to the plan group, so that users can quickly join multiple plans in batches.

1) In **[Plan Group]**, click Add, fill in the name of the plan group;

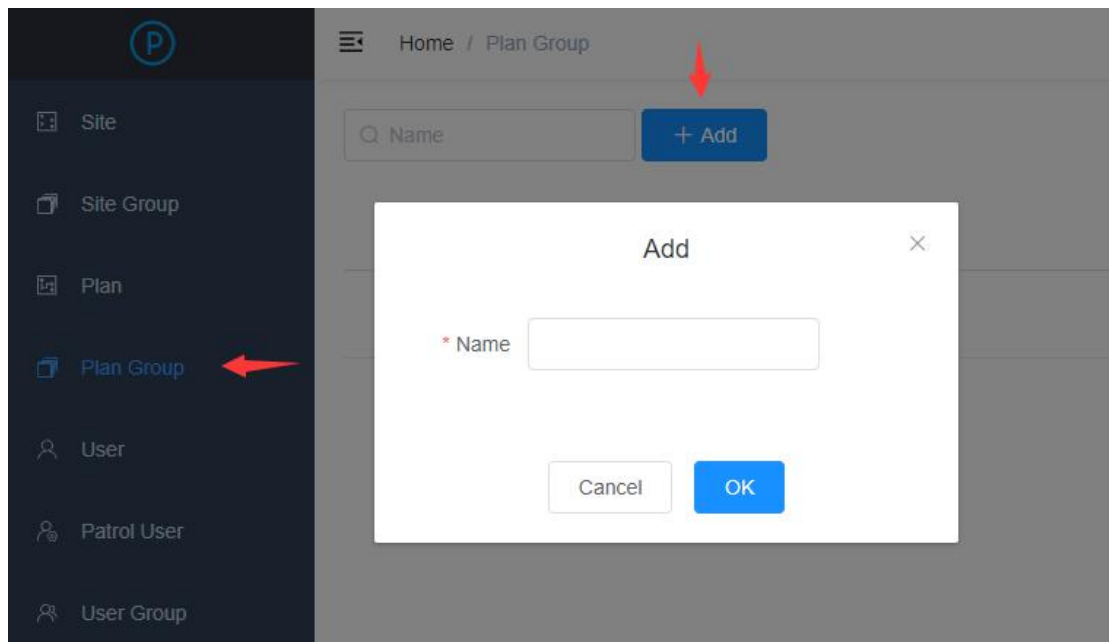

2) Click the **[Set Group]** button on the right to enter the plan group setting page. Add the plan on the left to the plan group, or remove the plan on the right from the plan group.

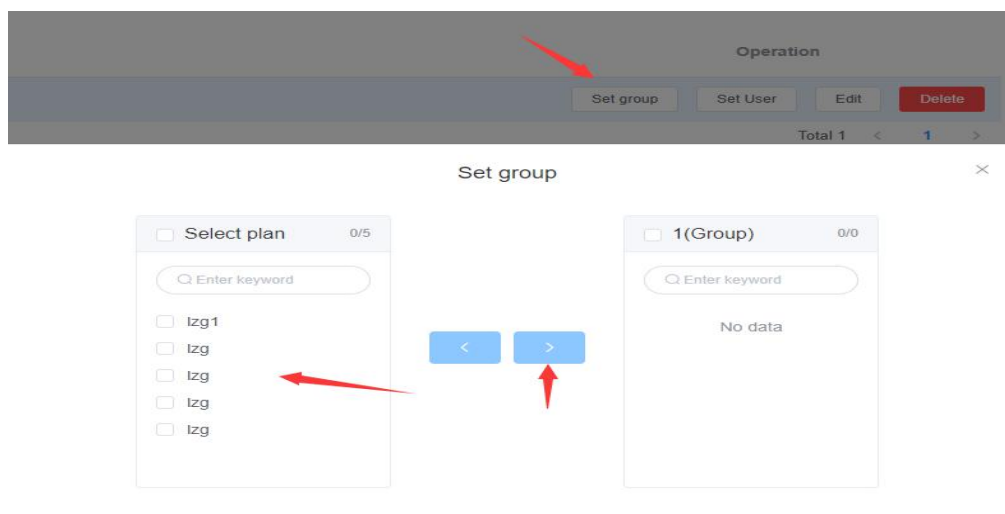

3) Click **[Set User]**, select a user group, and then select users in the group.

These users will be **added to all patrol plans in this plan group in batches.**

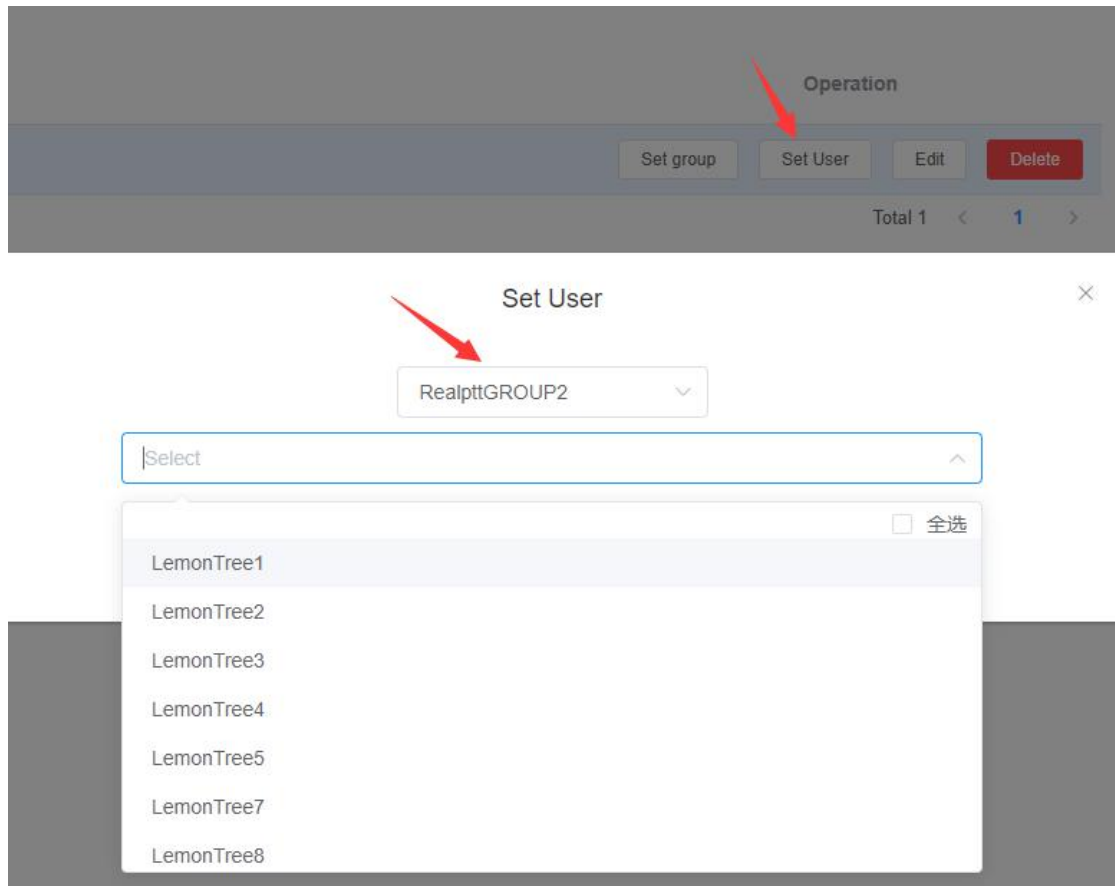

## 2.4 User

Check the patrol plan that the user has joined, and add a patrol plan to the user. You can add users to multiple patrol plans at once.

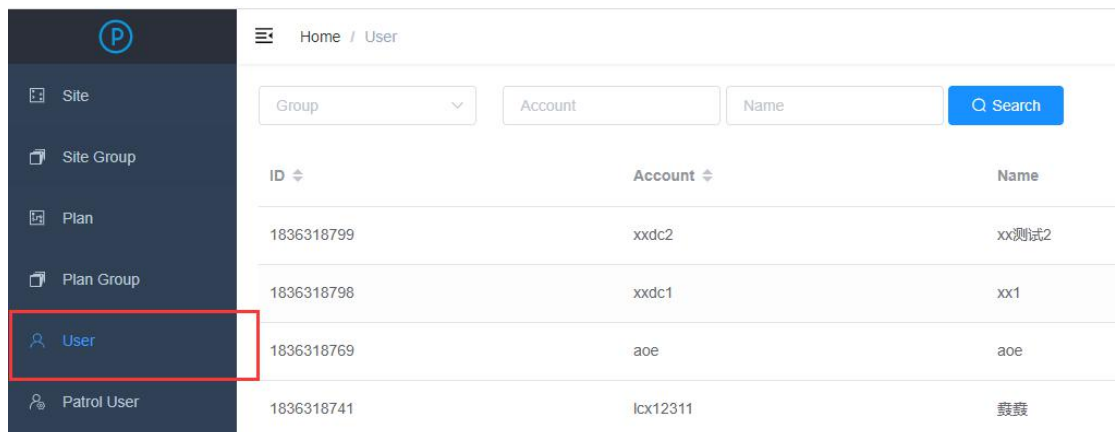

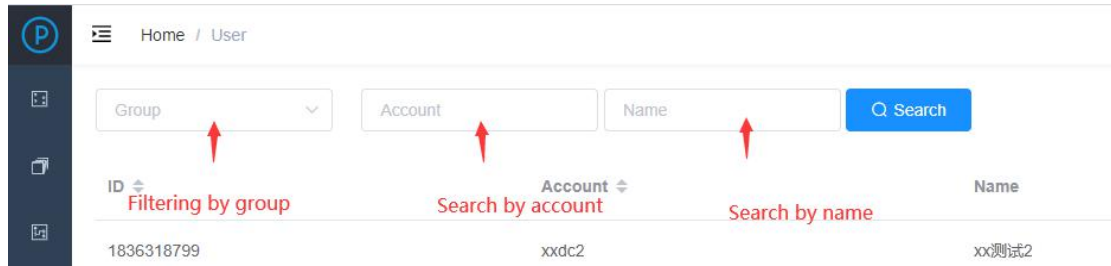

You can search for user plans by group, user account, and user name. All user plans in the enterprise are displayed by default. If the patrol function is displayed as "√", it means that the user is a user with patrol function.

Patrol Function	Operation
×	Set Plan
×	Set Plan
×	Set Plan
×	Set Plan

After clicking **[Set Plan]**, you can edit the plan bound to the user. You can delete the patrol plan that the user has bound to, or select the corresponding plan user binding through the "plan grouping". After adding, click OK to save successfully.

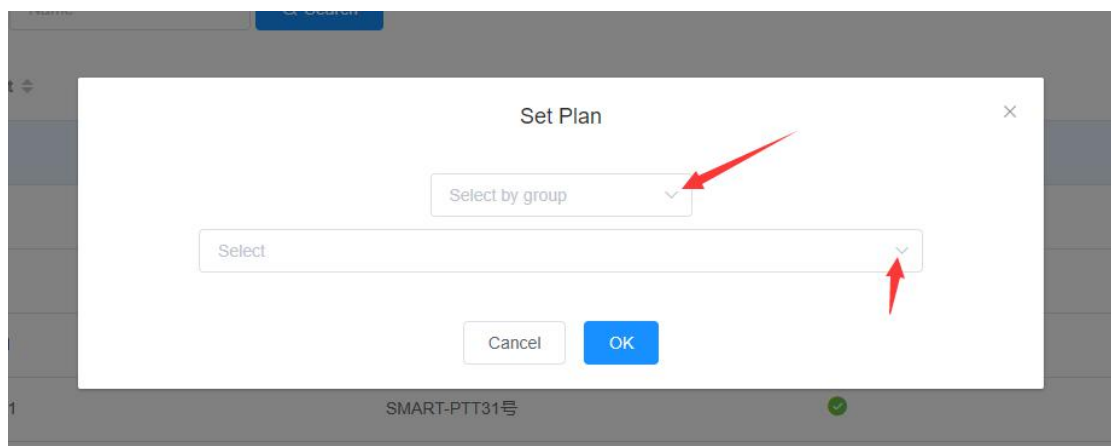

## 2.5 Patrol User

By searching for user accounts, user names, and plan names, you can query all plans bound to the user or all users corresponding to a plan, and you

can also delete unnecessary plans.

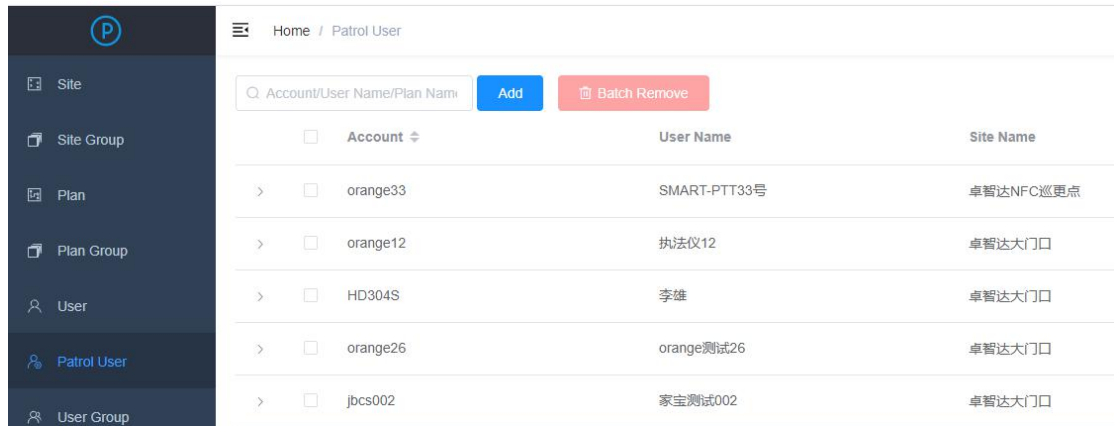

Click the **[Add]** button in the upper left corner of the [Patrol User] page to add plans to users. On the left, select one or more users in the specified group, and on the right, select one or more patrol plans in the specified plan group to add. It is suitable for adding multiple users to multiple patrol plans in batches.

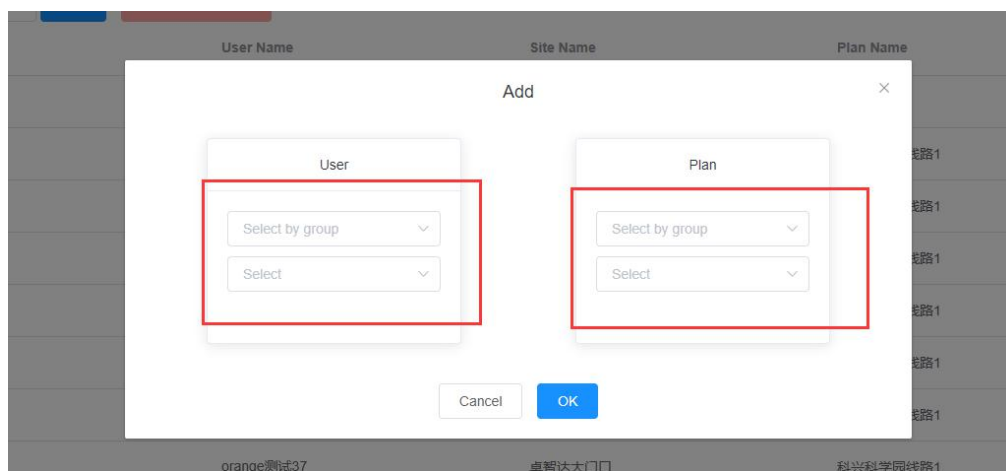
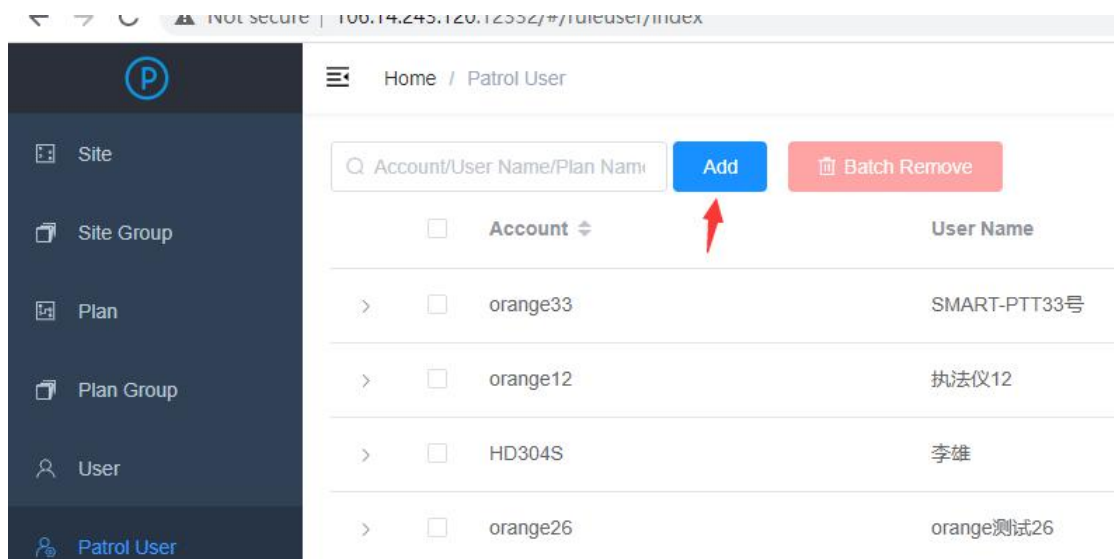

## 2.6 User Group

Can view all groups in the enterprise management platform, and can search by group ID and user name. When grouping users into the plan, you can select multiple users to join the plan at a time through the user group.

## 2.7 Patrol record

### 2.7.1 statistics

After the patrol sign-in is completed, all patrol records within **30** days except for the current day will be counted in the "Statistics" page. It can be filtered by parameters such as patrol point, patrol user, patrol plan, and planned time. The default is to display all the tour records of the previous day.

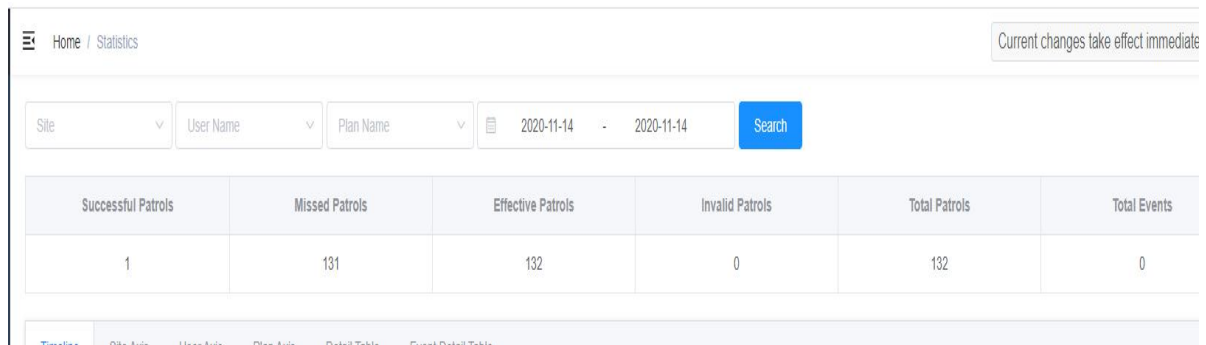

Successful Patrols	Missed Patrols	Effective Patrols	Invalid Patrols	Total Patrols	Total Events
1	131	132	0	132	0

Users can view all patrol records within 30 days. Including: successful inspections, missed inspections, valid inspections, invalid inspections, total inspections and total events.

You can choose the plan axis, user axis, and patrol point axis to view details, and you can view the situation intuitively through various forms of charts. Including: line chart, column chart, calendar chart, grid chart and other

## Calendar Chart

2020-11-14	
Successful Ratio:	0.8%
Successful Patrols:	1
Missed Patrols:	131
Events:	0
Out-of-plan Patrol:	0
Invalid Patrols:	0

chart forms.

Patrol Ratio Line Chart



Patrol Histogram

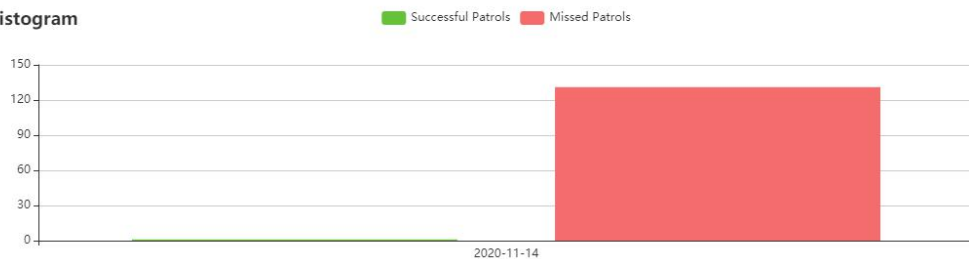

When you need to view the details of the patrol record, you can select the "details table" and "event details table" at the far right, search for the related patrol check-in records by searching for the user name or patrol point name, and you can view the patrol check-in records , Text content and multimedia data uploaded by users.

Timeline		Site Axis		User Axis		Plan Axis		Detail Table		Event Detail Table	
User Name		Site Name		Plan Name				Search			
User	Site	Plan	Start Time	End Time	Patrol Time						
> SMART-PTT33号	卓智达NFC巡更点	卓智达NFC	2020-11-14 15:00:00	2020-11-14 17:59:59	--						
> 执法仪12	卓智达大门口	科兴科学园线路1	2020-11-14 08:30:00	2020-11-14 16:00:00	--						
> 李雄	卓智达大门口	科兴科学园线路1	2020-11-14 08:30:00	2020-11-14 16:00:00	--						
> orange测试26	卓智达大门口	科兴科学园线路1	2020-11-14 08:30:00	2020-11-14 16:00:00	--						

## 2.7.2 Patrol Record Query

In the record query, you can view all the patrol check-in records within 30 days, and filter and query according to the user name, patrol point, and patrol time range.

Home / Patrol Record Query				
User Name	Site	2020-11-14 10:16:20	2020-11-15 10:16:20	Search
User Name	User ID	Site Name	Site ID	
apex5	1836318785	LZG	207	

## 2.7.3 Event Record Query

When the user patrols on the device, if the corresponding patrol point has set events and results. Users can choose corresponding events and results during the patrol according to their actual conditions, and choose to upload, text, pictures, audio, and video data.

Home / Event Record Query					
User Name	Site	2020-11-14 10:25:12	2020-11-15 10:25:12	Search	
User Name	User ID	Site Name	Site ID	Event Type	
No Data					

If the user uploads the multimedia data during the patrol check-in, it can be viewed online on this page or downloaded to the local for storage.

## 2.8 Dispatcher user

If the administrator needs to log in to the computer scheduling console to view the real-time patrol status of other users, he needs to add the administrator account as a patrol scheduling user, and assign the corresponding patrol point to this account, then the corresponding patrol can be viewed in the computer scheduling console All real-time patrol records of patrol points. The account can also log in to the mobile patrol dispatching station to view the patrol status of the corresponding personnel.

How to add: Click the "Add" button in the upper left corner, select a user group, and then select one or more users below. Select one or more patrol points in the same way on the right to add them.

After the addition is complete, you can see all the patrol points corresponding to each patrol computer scheduling user. You can edit it again, or directly delete the patrol point corresponding to the user.

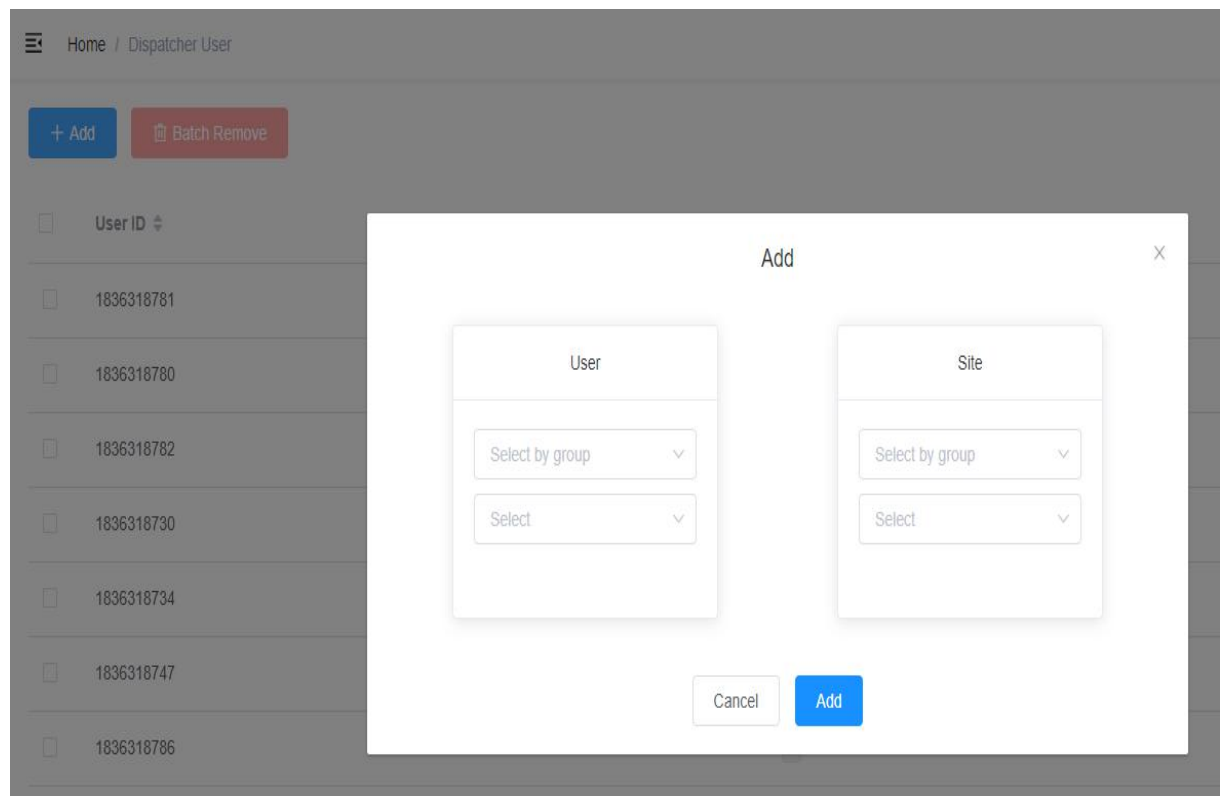

## 2.9 Mail Task

When the user needs to send the patrol statistical report of the day to the mailbox of the specified user, the mail sending function can be used. Set the time, time zone, and email address for sending each day. And you can set conditions and send specific patrol reports for designated plans, users or patrol points. The default is to send the patrol report of all patrol points of the company the previous day.

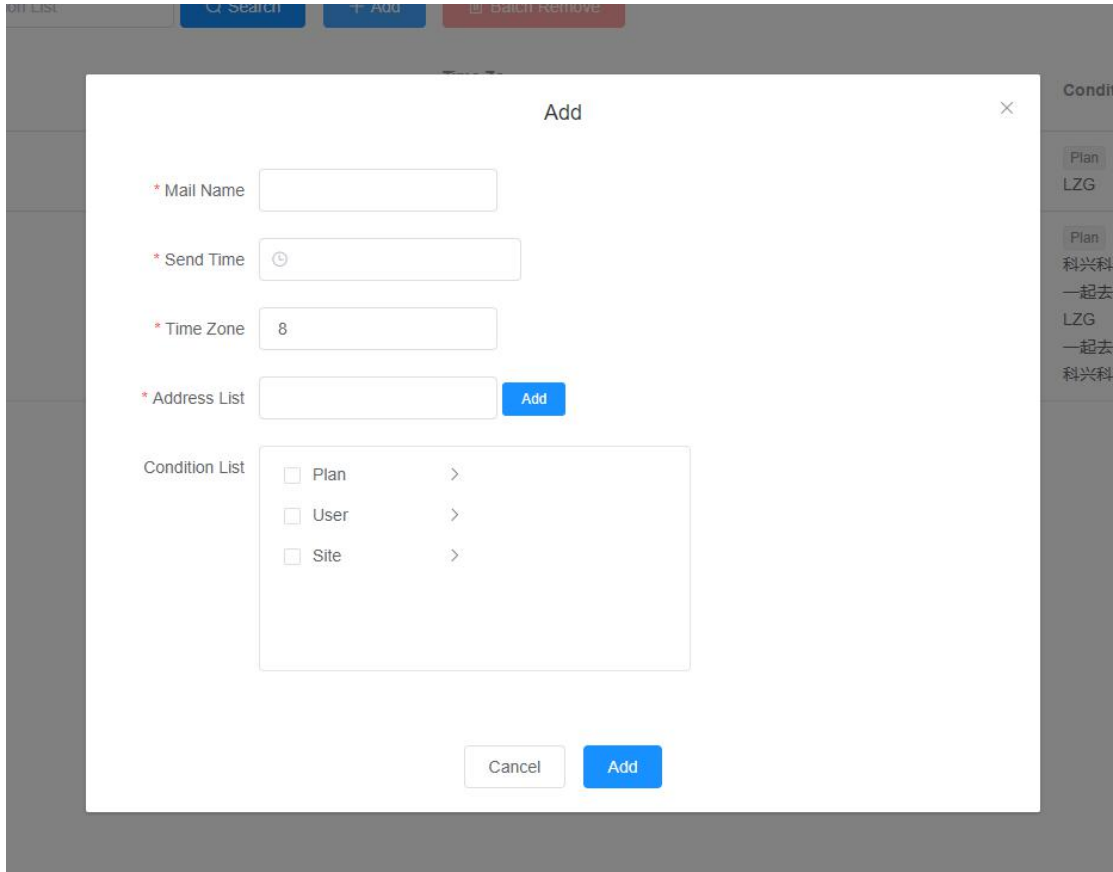

In the address list, you can click the **[Add]** button to set multiple email addresses.

## 2.10 company information

The company name, time zone, and number of inspection reminders are displayed. The RealPTT mobile dispatching station will carry out inspection reminders according to the settings.

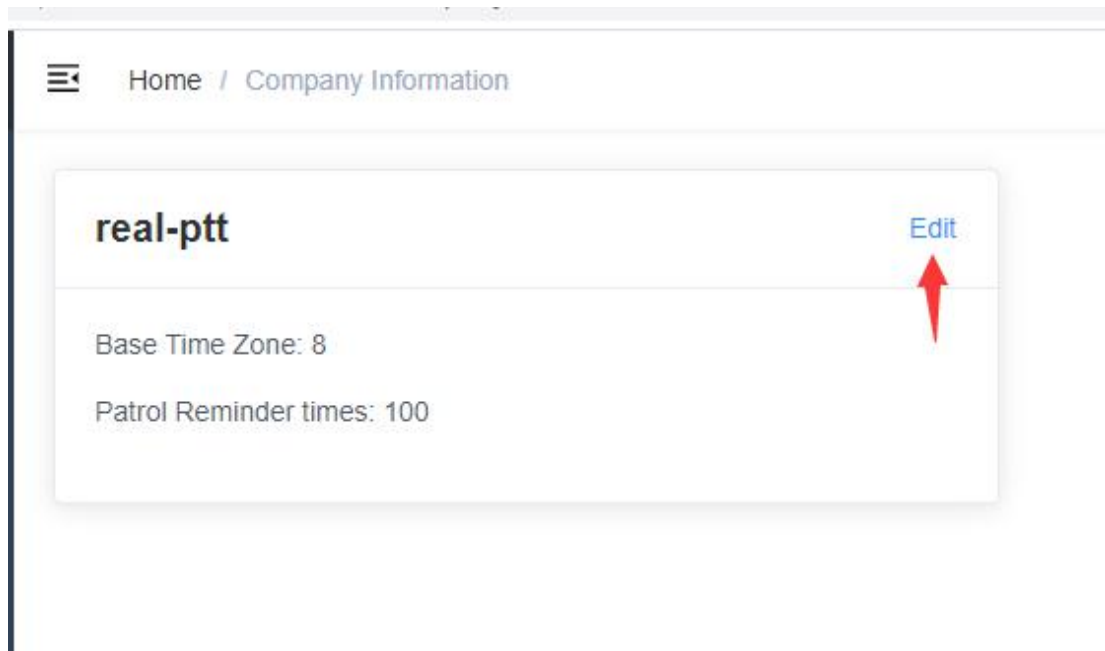

## 3、RealPTT Mobile dispatching desk

### 3.1.Patrol check-in

After the user logs into the Real-PTT software of the mobile phone with the intercom account, the patrol menu can be seen in the setting interface.

The following is a demonstration of the patrol process of GPS patrol points. The device turns on the GPS positioning function and locates it. When the patrol point is within the effective range, GPS patrol can be used.

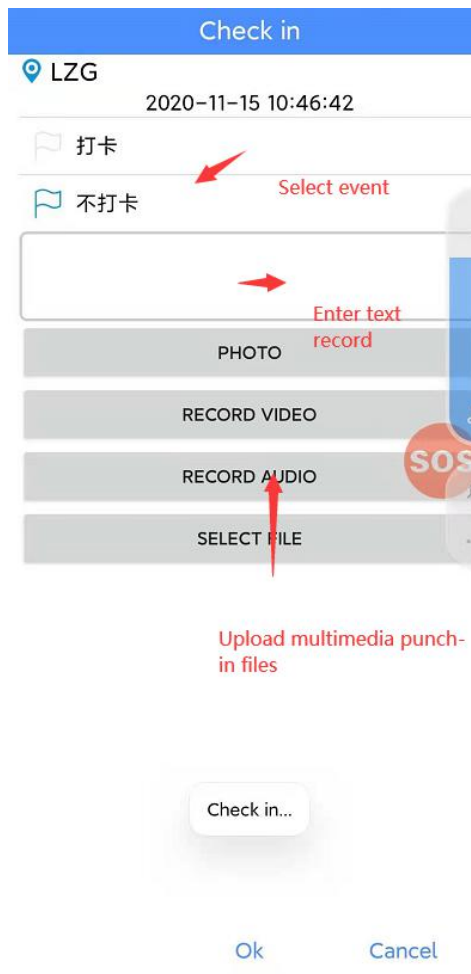
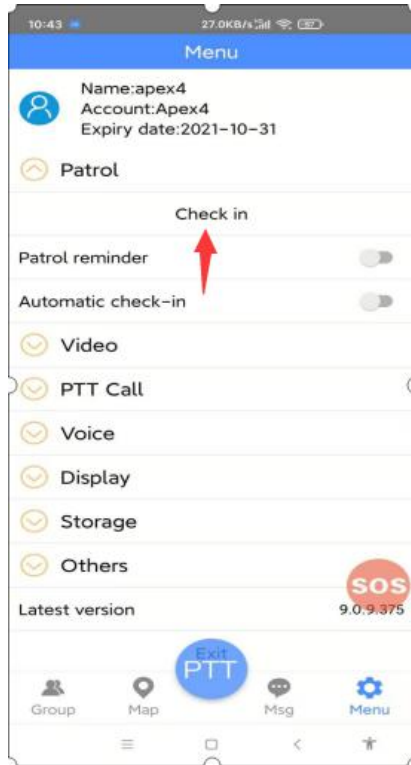

Patrol users select the corresponding patrol event and event result

according to the situation. Enter text description and upload pictures, audios, videos, etc., and the management station will receive the results of this patrol and the uploaded files.

If it is an NFC patrol point, the device needs to turn on the NFC switch, and then the device is close to the NFC card to perform the patrol operation.

### 3.2. Patrol reminder

The user logs in to the mobile phone Real-PTT dispatcher APP, if the patrol reminder switch is turned on in the settings. Then within the time range of the patrol plan, a total of three patrol reminders will be received. For example: 3 hours before the end of the patrol plan, you will receive the first reminder after logging in, and then you will receive it every 1 hour. A total of three patrol reminders were received.

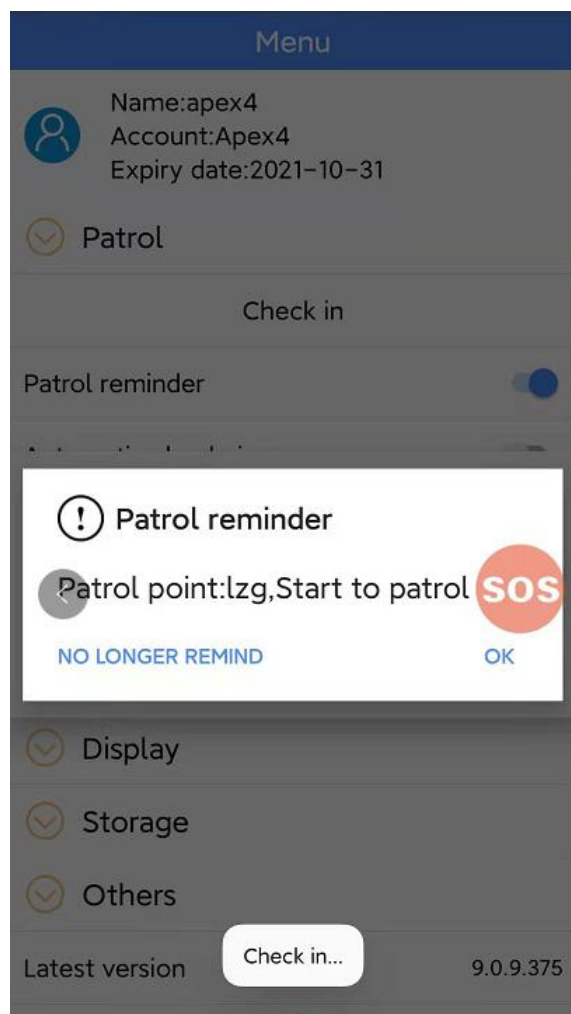

### 3.3. Automatic sign in

After the user logs in, it checks whether the device is within the GPS patrol point every 30 seconds. If it is, it will automatically patrol once. The patrol records can be viewed in the computer dispatching station or patrol management platform.

### 3.4 Error handling

When the device is patrolling, if the setting or patrol operation does not meet the usage conditions, the device will give corresponding prompts. The following are common prompts and their meanings:

- ① **Not within the range of the patrol point:** The device may not be within the range of the effective patrol point or the device may not be located, and there is no current position.
- ② **The patrol point is incorrect:** the patrol point bound to the current NFC card is not in the patrol plan that the user belongs to;
- ③ **Failed to parse the data:** Check whether there are multiple plans in the same time period set in the same GPS patrol point in the plan to which the user belongs.

## 4、 Computer side of patrol dispatching desk

### 4.1 Patrol plan

If the user needs to use the computer dispatching console to view the user's patrol details in real time, he must set the account to **"patrol dispatch account"** and **turn on the patrol 2.0 permission**. After logging in to the software, click the Patrol function button to enter the Patrol menu. The menu is divided into two versions, 1.0 and 2.0. Here we need to choose the 2.0 version.

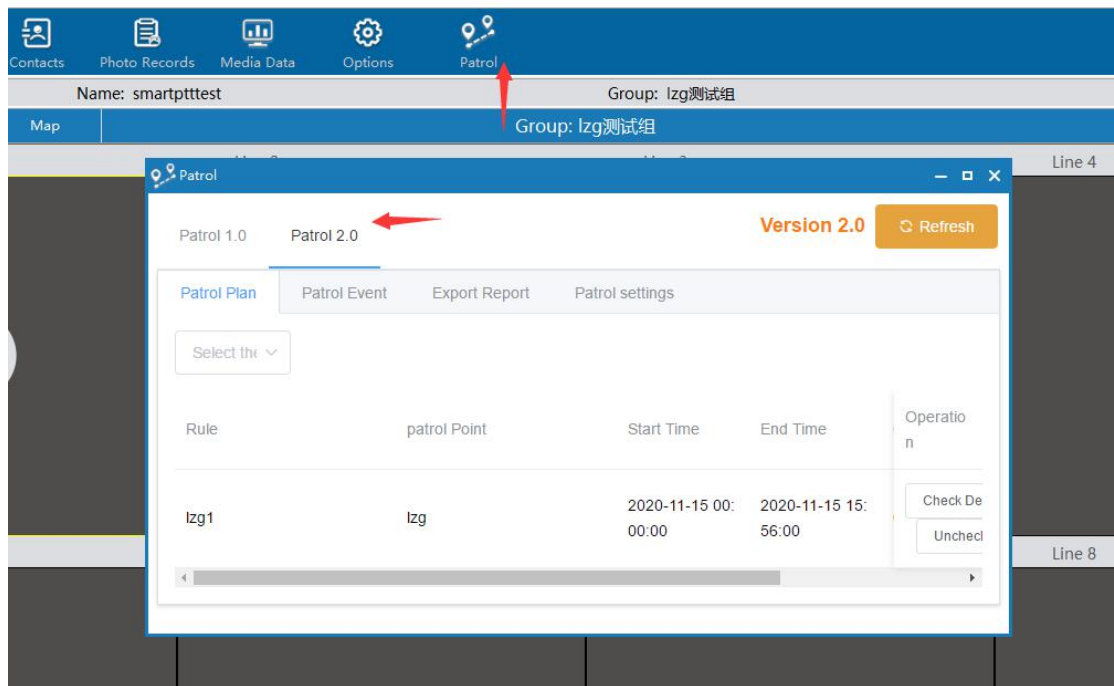

## 4.2. Patrol event

### 4.2.1 Patrol event reminder

After the user performs a patrol, the specific patrol details pop-up window will be displayed in the lower right corner of the computer control console.

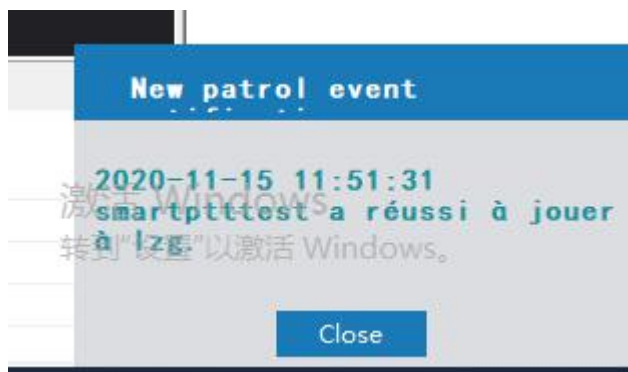

If the user patrols outside the scheduled time, the specific unpatrolled users can be seen on the patrol details page. Green is the successful patrol user, and red is the overtime patrol user.

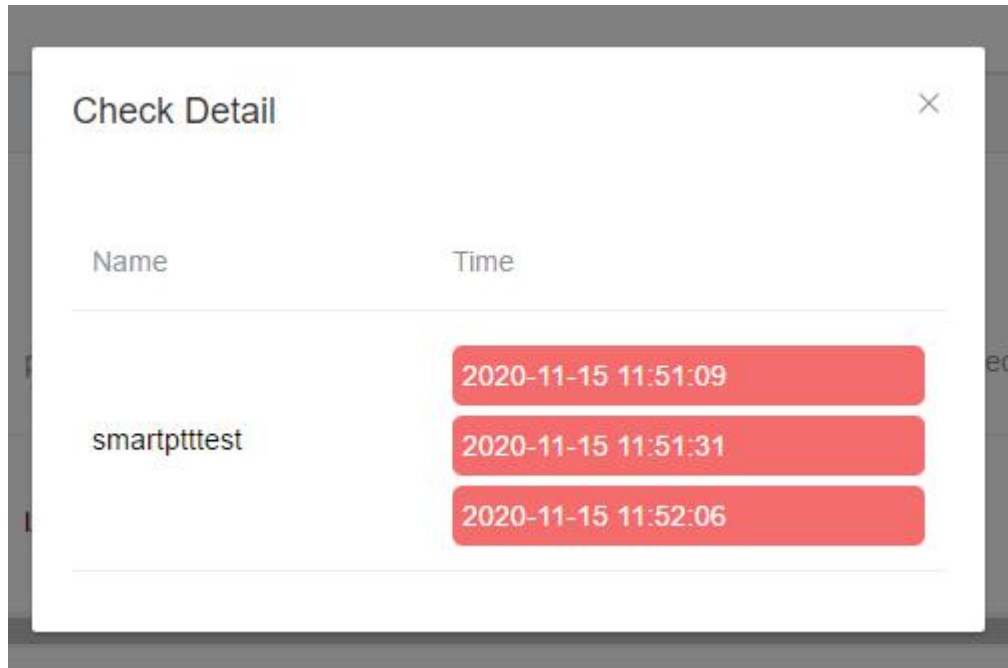

#### 4.2.2 Overtime plan

If the patrol plan is overtime and there are still unpatrolled users, a pop-up window will be displayed in the lower right corner of the computer dispatching console. Within 5 minutes of the timeout, a reminder will be made every 1 minute. The pop-up window needs to be closed manually.

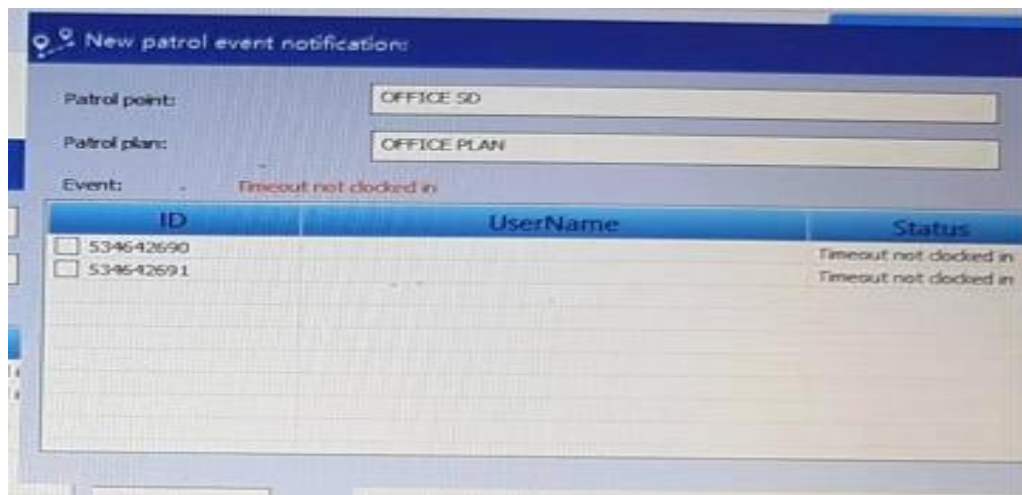

### 4.2.3 Patrol event

The user can view the event records uploaded by the patrol user on the patrol event page, including text, video, picture, and audio file records. And can be downloaded to the local save.

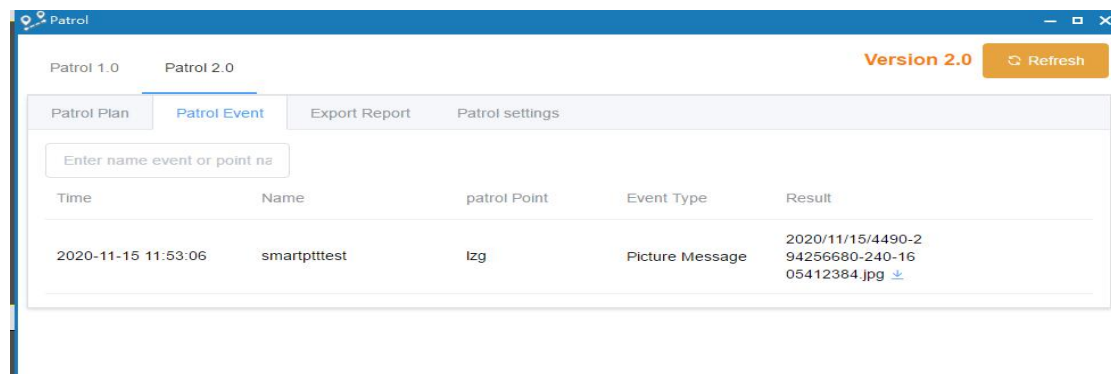

### 4.3 Export report

When the user needs to export the patrol record of the day, he can choose to export the patrol report. According to the needs of users, you can choose a date or a patrol plan to export.

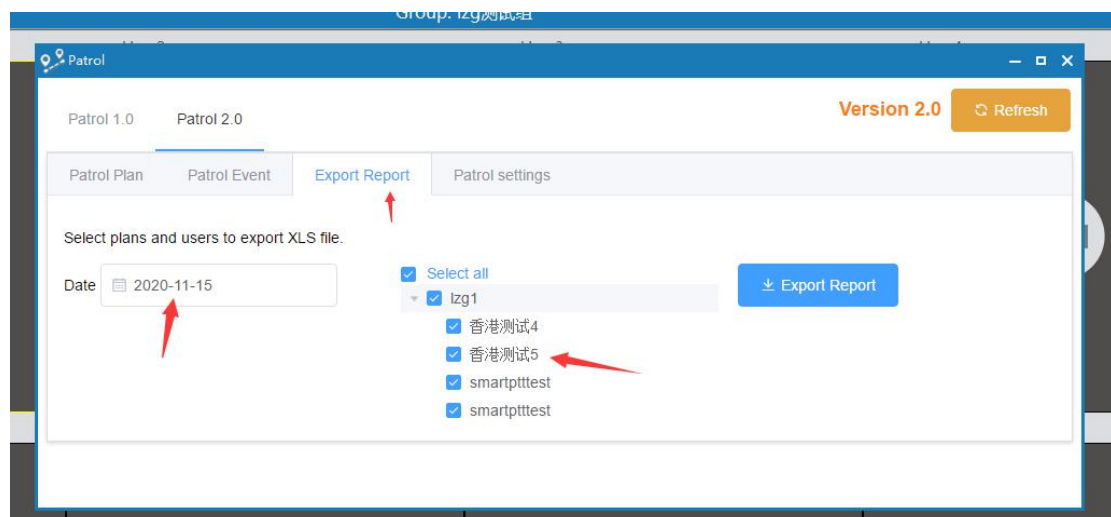

### 4.4 Patrol settings

